

## SDH type/ API Dual Plate Check Valve



### Standard and Scope:

Size: NPS 2"~48" DN50~DN1200

Pressure Rating: Class 150~2500 PN2.5~PN420

Connection: wafer type, flanged type, full lug type or split lug type, if required Butt weld end, Hub end also available

Material: Carbon steel, Stainless steel, Duplex, Super Duplex, Titanium, Inconel

Seat: Integral metal, metal insert and resilient seated (BUNA N, EPDM, Viton) are optional

Design and Manufacture: API594 and API 6D

Test and Inspection: API598, API6D, BS EN12569, EN12266.1

Pressure-temperature ratings: ASME B16.34.

Face-to-Face: API594, API6D, DIN3202, ISO 5752

End Connection: ASME B16.5 (for NPS≤24) ; ASME B 16.47 series B(our normal standard)、API 605 or ASME B16.47 series A、MSS SP-44 (for NPS>24; BS EN 1092-1

Pressure-temperature ratings: ASME B16.34

Working Temperature: -196 C~540 C

### Design feature

- Short face to face, small volume, light in weight, means economic and environmental
- Retainer less body
- Integral Seat
- Spring assisted, acts sensitively with perfect sealing effect
- Short disc travel, less impact force when closing
- One piece body, means simple and reliable
- Dual plate disc, renewable split disc
- Convenient in installation, Horizontal or vertical installation are available
- Close quickly with less hammer pressure
- Slim plate design, less flow resistance
- Longer service life with high reliability
- Corrosion protection, inside and outside epoxy coating if required

Typical Models: SDH76H/ SDH76W/SDH76Y

Wafer Type Duo Disc Spring Loaded Check Valve (Swing type Butterfly Check Valve) with 13Cr seat/Body material seat/Hard Alloy seat

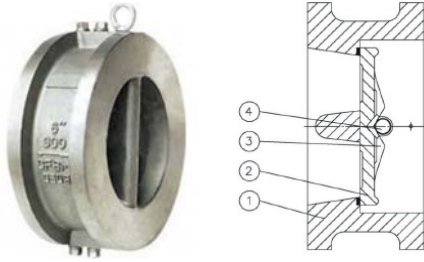

Major Parts Material Chart

| Parts No. | Part Name | Materials   |
|-----------|-----------|---|
| 1         | Body      | ASTM A216 WCB, ASTM A351 CF8, CF8M, CF8C, CF3, CF3M                               |
| 2         | Disc      | ASTM A216 WCB, ASTM A351 CF8, CF8M, CF8C, CF3, CF3M                               |
| 3         | Stem      | ASTM A182 F6a, F22, F304, F316, F321, F304L, F316L                                |
| 4         | Spring    | Stainless steel/Inconel; AISI 9260, AISI 6150, ASTM A182 F304, F316, F304L, F316L |

Note: The charts above just only list common combination of check valve. SGV able to offer other material if required.

Class 150 300 600 900 1500 2500

API Wafer Type Dual Plate Check Valve

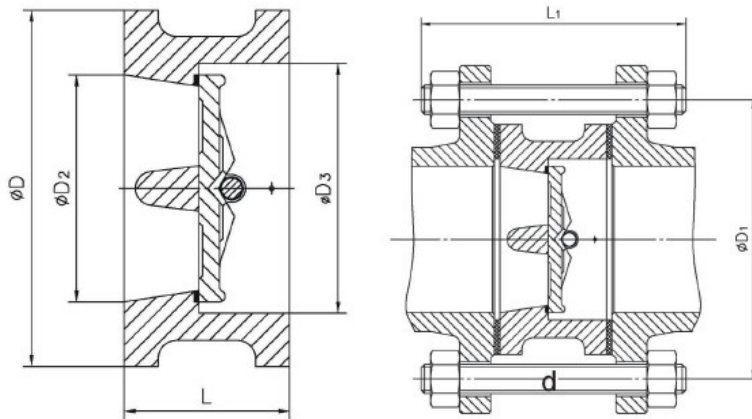

| Class | Size  |     | Dimension(mm) |     |     |     | Weight | Class | Size  |     | Dimension(mm) |     |     |     | Weight |
|-------|-------|-----|---------------|-----|-----|-----|--------|-------|-------|-----|---------------|-----|-----|-----|--------|
|       | NPS   | DN  | L             | D   | D2  | D3  | Kg     |       | NPS   | DN  | L             | D   | D2  | D3  | Kg     |
|       | 2     | 50  | 60            | 103 | 51  | 56  | 2      |       | 2     | 50  | 60            | 110 | 51  | 58  | 3      |
|       | 2 1/2 | 65  | 67            | 122 | 65  | 73  | 3.1    |       | 2 1/2 | 65  | 67            | 128 | 65  | 73  | 4      |
|       | 3     | 80  | 73            | 135 | 80  | 88  | 4      |       | 3     | 80  | 73            | 147 | 80  | 88  | 6      |
|       | 4     | 100 | 73            | 173 | 102 | 108 | 6      |       | 4     | 100 | 73            | 179 | 102 | 108 | 8      |
|       | 5     | 125 | 86            | 195 | 127 | 132 | 8      |       | 5     | 125 | 86            | 214 | 127 | 132 | 15     |
|       | 6     | 150 | 98            | 220 | 152 | 160 | 13     |       | 6     | 150 | 98            | 249 | 152 | 160 | 18     |
|       | 8     | 200 | 127           | 277 | 203 | 210 | 25     |       | 8     | 200 | 127           | 305 | 203 | 210 | 31     |
|       | 10    | 250 | 146           | 337 | 254 | 266 | 39     |       | 10    | 250 | 146           | 359 | 254 | 266 | 51     |
|       | 12    | 300 | 181           | 407 | 305 | 310 | 54     |       | 12    | 300 | 181           | 420 | 305 | 310 | 77     |

| 150   | 14    | 350  | 184           | 448  | 350  | 355  | 80     | 300   | 14    | 350  | 222           | 483  | 350  | 355  | 117    |
|-------|-------|------|---------------|------|------|------|--------|-------|-------|------|---------------|------|------|------|--------|
|       | 16    | 400  | 191           | 512  | 400  | 405  | 117    |       | 16    | 400  | 232           | 537  | 400  | 405  | 190    |
|       | 18    | 450  | 203           | 547  | 450  | 455  | 138    |       | 18    | 450  | 264           | 594  | 450  | 455  | 200    |
|       | 20    | 500  | 219           | 604  | 500  | 505  | 164    |       | 20    | 500  | 292           | 652  | 500  | 505  | 265    |
|       | 24    | 600  | 222           | 715  | 600  | 605  | 331    |       | 24    | 600  | 318           | 772  | 600  | 608  | 410    |
|       | 28    | 700  | 305           | 773  | 700  | 700  | 380    |       | 30    | 750  | 368           | 882  | 735  | 740  | 660    |
|       | 30    | 750  | 305           | 824  | 746  | 750  | 425    |       | 36    | 900  | 483           | 1044 | 873  | 880  | 1020   |
|       | 32    | 800  | 305           | 878  | 796  | 800  | 560    |       | 42    | 1050 | 568           | 1196 | 1035 | 1045 | 1540   |
|       | 36    | 900  | 368           | 983  | 898  | 910  | 640    |       | 48    | 1200 | 629           | 1365 | 1179 | 1190 | 2260   |
|       | 42    | 1050 | 432           | 1142 | 1050 | 1055 | 960    |       |       |      |               |      |      |      |        |
|       | 48    | 1200 | 524           | 1302 | 1200 | 1205 | 1400   |       |       |      |               |      |      |      |        |
| Class | Size  |      | Dimension(mm) |      |      |      | Weight | Class | Size  |      | Dimension(mm) |      |      |      | Weight |
|       | NPS   | DN   | L             | D    | D2   | D3   | Kg     |       | NPS   | DN   | L             | D    | D2   | D3   | Kg     |
| 600   | 2     | 50   | 60            | 110  | 51   | 58   | 4      | 900   | 2     | 50   | 70            | 140  | 51   | 58   | 8      |
|       | 2 1/2 | 65   | 67            | 128  | 65   | 73   | 5      |       | 2 1/2 | 65   | 83            | 162  | 65   | 73   | 11     |
|       | 3     | 80   | 73            | 147  | 80   | 88   | 8      |       | 3     | 80   | 83            | 165  | 80   | 88   | 14     |
|       | 4     | 100  | 79            | 191  | 102  | 108  | 11     |       | 4     | 100  | 102           | 204  | 102  | 108  | 20     |
|       | 5     | 125  | 105           | 239  | 127  | 136  | 20     |       | 5     | 125  | 110           | 245  | 127  | 136  | 30     |
|       | 6     | 150  | 136           | 264  | 152  | 162  | 26     |       | 6     | 150  | 159           | 286  | 152  | 162  | 42     |
|       | 8     | 200  | 165           | 318  | 200  | 212  | 55     |       | 8     | 200  | 206           | 356  | 200  | 212  | 84     |
|       | 10    | 250  | 213           | 398  | 250  | 266  | 95     |       | 10    | 250  | 241           | 432  | 250  | 266  | 145    |
|       | 12    | 300  | 229           | 455  | 305  | 312  | 140    |       | 12    | 300  | 292           | 495  | 305  | 312  | 220    |
|       | 14    | 350  | 273           | 490  | 337  | 355  | 223    |       | 14    | 350  | 356           | 518  | 337  | 355  | 350    |
|       | 16    | 400  | 305           | 562  | 387  | 400  | 360    |       | 16    | 400  | 384           | 572  | 387  | 400  | 470    |
| 18    | 450   | 362  | 610           | 438  | 459  | 395  | 18     | 450   | 451   | 635  | 438           | 459  | 605  |      |        |
| 20    | 500   | 368  | 680           | 489  | 500  | 518  | 20     | 500   | 451   | 695  | 489           | 500  | 820  |      |        |
| 24    | 600   | 438  | 786           | 591  | 600  | 836  | 24     | 600   | 495   | 835  | 591           | 600  | 1050 |      |        |
| Class | Size  |      | Dimension(mm) |      |      |      | Weight | Class | Size  |      | Dimension(mm) |      |      |      | Weight |
|       | NPS   | DN   | L             | D    | D2   | D3   | Kg     |       | NPS   | DN   | L             | D    | D2   | D3   | Kg     |
| 1500  | 2     | 50   | 70            | 140  | 51   | 58   | 8      | 2500  | 2     | 50   | 70            | 14   | 42   | 48   | 10     |
|       | 2 1/2 | 65   | 83            | 162  | 65   | 73   | 11     |       | 2 1/2 | 65   | 83            | 166  | 52   | 58   | 18     |
|       | 3     | 80   | 83            | 172  | 80   | 88   | 19     |       | 3     | 80   | 86            | 194  | 62   | 68   | 26     |
|       | 4     | 100  | 102           | 207  | 102  | 108  | 26     |       | 4     | 100  | 105           | 232  | 88   | 94   | 40     |
|       | 5     | 125  | 110           | 252  | 127  | 136  | 51     |       | 5     | 125  | 110           | 277  | 100  | 106  | 59     |
|       | 6     | 150  | 159           | 280  | 152  | 162  | 68     |       | 6     | 150  | 159           | 315  | 150  | 162  | 90     |
|       | 8     | 200  | 206           | 350  | 200  | 212  | 130    |       | 8     | 200  | 206           | 385  | 180  | 186  | 150    |
|       | 10    | 250  | 248           | 433  | 250  | 266  | 210    |       | 10    | 250  | 254           | 474  | 225  | 232  | 240    |
|       | 12    | 300  | 305           | 518  | 305  | 312  | 384    |       | 12    | 300  | 305           | 547  | 266  | 272  | 440    |
|       | 14    | 350  | 356           | 576  | 337  | 355  | 550    |       |       |      |               |      |      |      |        |
|       | 16    | 400  | 384           | 639  | 387  | 400  | 635    |       |       |      |               |      |      |      |        |

NOTE: The material in this catalog is for general information. For specific performance data, proper material selection and special design, consult us freely. Although every attempt has been made to ensure correct information, Sangong reserves the right to change designs, materials or specifications without notice.